



City of Hogansville  
City Council  
Work Session Meeting Agenda

**Monday, November 6, 2023 – 5:30 pm**

*Meeting will be held at Hogansville City Hall*

Mayor: <b>Jake Ayers</b>	2025	City Manager: <b>Lisa E. Kelly</b>
Council Post 1: <b>Michael Taylor, Jr</b>	2025	Assistant City Manager: <b>Niles Ford</b>
Council Post 2: <b>Matthew Morgan</b>	2025	City Attorney: <b>Alex Dixon</b>
Council Post 3: <b>Mandy Neese*</b>	2023	Chief of Police: <b>Jeffrey Sheppard</b>
Council Post 4: <b>Mark Ayers</b>	2023	City Clerk: <b>LeAnn Lehigh</b>
Council Post 5: <b>Toni Striblin</b>	2023	* Mayor Pro-Tem

**WORK SESSION – 5:30 pm**

**ORDER OF BUSINESS**

1. Meriwether County Water & Sewerage Authority Proposal for Waste Water Services
2. Royal Theater Change Orders Recommendations and Notice to Proceed on Phase 2

CITY COUNCIL  
Mayor Jake Ayers  
Michael Taylor, Jr., Post 1  
Mathew Morgan, Post 2  
Mandy Neese, Post 3  
Mark Ayers, Post 4  
Toni Striblin, Post 5



City Manager – Lisa Kelly  
Assistant City Manager – Niles Ford  
City Attorney – Alex Dixon

111 High St  
Hogansville GA 30230-1196  
706-637-8629 | cityofhogansville.org

**COUNCIL ACTION FORM**

**MEETING DATE:** November 6, 2023

**SUBMITTED BY:** Lynne Miller *LSM*

**AGENDA TITLE:** Royal Theater – Change Order Approvals and Notice to Proceed with Phase II

**CLASSIFICATION** (City Attorney must approve all ordinances, resolutions and contracts as to form)

- |                                                |                                     |                                                       |                                         |
|------------------------------------------------|-------------------------------------|-------------------------------------------------------|-----------------------------------------|
| <input type="checkbox"/> Ordinance (No. ____)  | <input type="checkbox"/> Contract   | <input type="checkbox"/> Information Only             | <input type="checkbox"/> Public Hearing |
| <input type="checkbox"/> Resolution (No. ____) | <input type="checkbox"/> Ceremonial | <input checked="" type="checkbox"/> Discussion/Action | <input type="checkbox"/> Other          |

**BACKGROUND** (Includes description, background, and justification)

Royal Theater work is approximately 25% complete. Principle Construction is finishing up Phase I and approaching Phase II, with an overall completion date set for June 2024.

Attached are 4 change orders that add to \$222,427, against Principle’s original contract total of \$2,240,000: (1) (Rev) - \$159,199 – for increased material costs due to 90-day lapse, and (2) \$8,161 (3) \$4,358 and (4) \$50,709 –for field changes. We are requesting City Council to approve these 4 change orders and issue Notice to Proceed with Phase II to Principle Construction.

A funding status report is also attached (one page). As of 10-31-23, Principle has been paid \$493,673.79. Dunwody-Beeland Architects have been paid \$71,268.62 so far. Royal Theater funds on hand = \$423,432. We have \$1,964,270 in approved grants not yet tapped. This will leave \$418,948.79 after Principle is fully paid \$2,240,000 for Phases 1 and 2 plus \$222,427 for the 4 change orders.

Additional costs will include AV/lights and film technology at an estimated \$400,000, remaining New Ground technology consulting fee of \$65,000, and Dunwody-Beeland fee of \$101,101. Those 3 additional costs total \$566,101.  $\$566,101 - \$418,948.79 = \$147,152.21$  additional funds that could be needed for this project.

**BUDGETING & FINANCIAL IMPACT** (Includes project costs and funding sources)

NA.

**STAFF RECOMMENDATION** (Include possible options for consideration)

Staff recommends City Council approve Principle Construction’s 4 change orders totaling \$222,427 and issue Notice to Proceed with Phase II to Principle Construction, with an updated total Phase I and Phase II price of \$2,462,427.

Royal Theater Expenses and Funds - October 31, 2023 - (with spire)			
<b><u>Principle Contract</u></b>			
Contract Amount	\$2,240,000.00		
Paid to Principle through 31 Oct 2023	\$493,673.79	\$1,746,326.21	
Change Order 1 Rev 1 (90-day material price increases)	\$159,199.00		
Change Order 2	\$8,161.00		
Change Order 3	\$4,358.00		
Change Order 4	\$50,709.00		
Change Order total (through 31 Oct 2023)		\$222,427.00	
Balance owed Principle (31 Oct 2023)			\$1,968,753.21
<b><u>Royal Funds on Hand</u></b>			
SPLOST 2013	\$90,714.00		
GA Fund 1	\$332,718.00	\$423,432.00	
Total funds on hand			
<b><u>Grants Awarded but not Drawn</u></b>			
EDA	\$1,789,270.00		
JHJ - 2nd contribution	\$100,000.00		
Fox Theatre	\$75,000.00		
Total Grants Awarded by not Drawn		\$1,964,270.00	
Funds on Hand + Grants not spent			\$2,387,702.00
Remaining funds after Principle Contract			\$418,948.79
<b><u>Additional Costs</u></b>			
New Ground Fee (after \$15,000 paid)	\$65,000.00		
AV/Lights & film estimate	\$400,000.00		
D'wody B'land - 7% construction cost after \$71,268.62 pd	\$101,101.00		
Additional costs total			\$566,101.00
Additional funds needed			\$147,152.21





**PRINCIPLE**  
CONSTRUCTION

# Change Order Request

**Project:** The Royal Theater  
400 East Main Street

**COR#:** 1-REV1

**To:** City of Hogansville  
111 High Street  
Hogansville, GA 30230

**Date:** 10/11/2023

**Re:** Price Increases for Phase 2 work

**Description of Change:**

Material price increases over and above original bid pricing due to 90+ day lapse.

**Total Cost**  
**Change in Contract Time**

**ADD** \$159,199  
None

**Attachments:**  Pricing Breakdown  Other \_\_\_\_\_

**Signed By:**   
General Contractor

10-11-23

**Date**

**Reviewed By:** \_\_\_\_\_  
Architect

**Date**

**Approved By:** \_\_\_\_\_  
Owner

**Date**

Please contact me with any questions that may arise concerning this change order request.

Project The Royal Theater  
 Location: 400 East Main Street  
 Description: Price Increases for Phase 2 work

**PRICING SHEET**

COR: 1-REV1  
 Date 11-Oct-23  
 Pricing By J.L.

CODE	DESCRIPTION OF WORK	QUANTITY	UNIT	LABOR		MATERIAL		RENTAL EQMT		SUBCONTRACTS		TOTAL
				UNIT	AMOUNT	UNIT	AMOUNT	UNIT	AMOUNT	UNIT	AMOUNT	
					0		0				0	0
					0		0				0	0
3.210	Cast-in-place Concrete / Reinforcing Materials Increase	1	LS		0	2,875	2,875		0		0	2,875
4.200	Masonry Reinforcing Materials Increase	1	LS		0	1,700	1,700		0		0	1,700
5.500	Metal Fabrications - Railings Materials Increase	1	LS		0	5,470	5,470		0		0	5,470
6.110	Wood Trim Material / Tooling / Setup Increase	1	LS		0	4,915	4,915		0		0	4,915
6.400	Interior Architectural Decorative Panels Materials Increase	1	LS		0	3,200	3,200		0		0	3,200
8.100	Hollow Metal Doors & Frames Materials Increase	1	LS		0	2,315	2,315		0		0	2,315
8.200	Wood Doors Material / Tooling / Setup Increase	1	LS		0	3,729	3,729		0		0	3,729
8.500	Windows / Aluminum Storefront Materials Increase	1	LS		0	1,869	1,869		0		0	1,869
8.700	Hardware Material - Allowance Overage	1	LS		0	3,070	3,070		0		0	3,070
9.260	Drywall / Metal Furring / Scaffolding Materials Increase	1	LS		0	41,803	41,803		0		0	41,803
9.900	Painting and Coatings Materials Increase	1	LS		0	4,387	4,387		0		0	4,387
10.100	Neon Signage Increase	1	LS		0	10,754	10,754		0		0	10,754
10.340	Decorative Spire Increase - The Sign Shop	1	LS		0	0	0		0	23,171	23,171	23,171
10.520	Fire Extinguishers & Cabinets not in drawings, per RFI #2	1	LS	175	175	2,829	2,829		0		0	3,004
10.530	Protective Covers / Canopies Increase	1	LS		0	3,700	3,700		0		0	3,700
15.700	Unite ACU-3, EF-5, EF-6 Materials Increase	1	LS		0	4,417	4,417		0		0	4,417
16.100	Electrical - Lighting-Non Revision 4 Increase	1	LS		0	7,338	7,338		0		0	7,338
					0		0		0		0	0
					0		0		0		0	0
					0		0		0		0	0
					0		0		0		0	0
					0		0		0		0	0
	Clean-Up and Disposal		mh		0		0		0		0	0
	Drawing Reproduction		ls		0		0		0		0	0
	Safely - (3% of Labor)			3%	5		0		0		0	5
	<b>SUBTOTAL</b>				180		104,371		0		23,171	127,722
	<b>LABOR BURDEN / SALES TAX</b>			32.0%	58	7%	7,306	7%	0		0	7,364
	<b>SUBTOTAL</b>				238		111,677		0		23,171	135,086
	<b>PROJECT INSURANCE</b>			1.1%								1,486
	<b>PROJECT BONDS</b>			1.75%								2,364
	<b>FEE (Overhead 5% &amp; Markup 10%)</b>			15%	36	15%	16,752	15%	0	15%	3,476	20,263
	<b>SUBTOTAL</b>				274		128,429		0		26,647	159,199
	<b>TOTAL</b>				274		128,429		0		26,647	159,199



# Quote

Date	Quote #
9/27/2023	8735
Quote Valid for 120 days	

Name / Address
PRINCIPAL CONSTRUCTION 51 NEW HUTCHINSON MILL RD LAGRANGE, GA 30240

Project Name
ROYAL THEATRE

P.O. No.	Rep
	ML

Qty	Description	Rate	Total
1	<p>FABRICATION OF DECORATIVE SPIRE FOR TOP OF ROYAL THEATRE IN HOGANSVILLE, GEORGIA.</p> <p>STRUCTURE HAS A CENTER 4" SCHEDULE 40 STEEL PIPE AT THE BASE WITH A 2" SCHEDULE 40 PIPE INSERTED AND WELDED WITH RINGS INSIDE THE 4" AND THEN A 1" PIPE WELDED IN THE 2" SECTION.</p> <p>THE BASE PORTION WILL HAVE TWO MATCHING STEEL MOUNTING PLATES TO WELD TO THE EXISTING STEEL PIPE IN ROOF. (AN ALTERNATE MOUNTING METHOD MAY BE USED ONCE A SURVEY IS PERFORMED). EACH PORTION OF THE DESIGN WILL HAVE A STEEL ANGLE FRAME THAT IS PRIMED AND PAINTED, 32" TALL X 30" DIAMETER ROUND BASE IS ROLLED STEEL WITH A 12" TALL DECORATIVE COPPER SECTION, SECOND 19" TALL SECTION IS ROLLED AND FORMED STEEL WITH DECORATIVE TRIM. BOTH BOTTOM SECTIONS HAVE A CENTER SLEEVE FOR A 4" ROUND PIPE AND ARE SEALED ON ALL EDGES AND SEAMS.</p> <p>FOUR DECORATIVE FEATHERED SECTIONS ARE 60.375" TALL X 17.5" WIDE FABRICATED IN A V SECTION WIDER IN THE BACK THAN THE FRONT. EACH SECTION IS FABRICATED WITH A STEEL FRAME WITH DECORATIVE COPPER ON THE FORWARD EDGE AND 1"THICK ROUTED FEATHERS ON EACH SIDE OF THE BACK SECTION. THE FEATHERED SECTIONS STAND SLIGHTLY PROUD OF THE</p>	88,478.00	88,478.00T

		<b>Subtotal</b>
--	--	-----------------

<p>Make checks payable to: The Sign Store Online, Inc - PO Box 20776 - Macon, GA 31205</p>	<b>Sales Tax (7.0%)</b>
------------------------------------------------------------------------------------------------	-------------------------

Signature _____	Date _____	<b>Total</b>
-----------------	------------	--------------



# Quote

Date	Quote #
9/27/2023	8735
Quote Valid for 120 days	

Name / Address
PRINCIPAL CONSTRUCTION 51 NEW HUTCHINSON MILL RD LAGRANGE, GA 30240

Project Name
ROYAL THEATRE

P.O. No.	Rep
	ML

Qty	Description	Rate	Total
1	<p>FRAME. TWO ROWS OF CURVED NEON ARE INCLUDED ON EACH SIDE OF EACH SECTION.</p> <p>THREE DECORATIVE FUNNEL SECTIONS 18.3" TALL X 24" DIAMETER, 10.3" TALL X 18" DIAMETER, 10.3" TALL X 12" DIAMETER. EACH FUNNEL HAS A CIRCLE NEON CAP</p> <p>OVERALL HEIGHT OF THE SPIRE IS 220"</p> <p>TWO TRUCKS AND CREWS TO SET DECORATIVE SPIRE ON ROOF OF THEATRE. PRICE INCLUDES TRAVEL, PER DIEM AND FUEL CHARGES</p>	15,750.00	15,750.00
		<b>Subtotal</b>	\$104,228.00
<p>Make checks payable to: The Sign Store Online, Inc - PO Box 20776 - Macon, GA 31205</p>		<b>Sales Tax (7.0%)</b>	\$6,193.46
		<b>Total</b>	\$110,421.46

Signature \_\_\_\_\_ Date \_\_\_\_\_







**PRICING SHEET**

CODE	DESCRIPTION OF WORK	QUANTITY	UNIT	LABOR		MATERIAL		RENTAL EQMT		SUBCONTRACTS		TOTAL
				UNIT	AMOUNT	UNIT	AMOUNT	UNIT	AMOUNT	UNIT	AMOUNT	
3.210	Cast-in-place Concrete / Reinforcing Materials Increase	1	LS		0		0				0	
4.200	Masonry Reinforcing Materials Increase	1	LS		0	2,875	2,875				0	2,875
5.500	Metal Fabrications - Railings Materials Increase	1	LS		0	1,700	1,700				0	1,700
6.110	Wood Trim Material / Tooling / Setup Increase	1	LS		0	5,470	5,470				0	5,470
6.400	Interior Architectural Decorative Panels Materials Increase	1	LS		0	4,915	4,915				0	4,915
8.100	Hollow Metal Doors & Frames Materials Increase	1	LS		0	3,200	3,200				0	3,200
8.200	Wood Doors Material / Tooling / Setup Increase	1	LS		0	2,315	2,315				0	2,315
8.500	Windows / Aluminum Storefront Materials Increase	1	LS		0	3,729	3,729				0	3,729
8.700	Hardware Material - Allowance Overage	1	LS		0	1,869	1,869				0	1,869
9.260	Drywall / Metal Furring / Scaffolding Materials Increase	1	LS		0	3,070	3,070				0	3,070
9.900	Painting and Coatings Materials Increase	1	LS		0	41,803	41,803				0	41,803
10.100	Neon Signage Increase	1	LS		0	4,387	4,387				0	4,387
10.340	Decorative Spire Increase - Mitch Kernodle	1	LS		0	10,754	10,754				0	10,754
10.520	Fire Extinguishers & Cabinets not in drawings, per RFI #2	1	LS	175	175	2,829	2,829				0	3,004
10.530	Protective Covers / Canopies Increase	1	LS		0	3,700	3,700				0	3,700
15.700	Units ACU-3, EF-5, EF-6 Materials Increase	1	LS		0	4,417	4,417				0	4,417
16.100	Electrical - Lighting-Non Revision 4 Increase	1	LS		0	7,338	7,338				0	7,338
	Clean-Up and Disposal		mh		0		0				0	
	Drawing Reproduction		ls		0		0				0	
	Safety - (3% of Labor)			3%	5		0				0	
	<b>SUBTOTAL</b>				180		104,371				13,750	118,121
	LABOR BURDEN / SALES TAX			32.0%	58		7,306		7%		0	7,306
	<b>SUBTOTAL</b>				238		111,677				13,750	125,427
	PROJECT INSURANCE			1.1%								1,38
	PROJECT BONDS			1.75%								2,19
	FEE (Overhead 5% & Markup 10%)			15%	36		16,752		15%		2,063	18,815
	<b>SUBTOTAL</b>				274		128,429				15,813	144,242
	<b>TOTAL</b>				274		128,429				15,813	144,242



116 Swift Street, LaGrange, Ga. 30240  
Phone: 706-884-5621 Fax: 706-882-3589

**Project:** The Royal Theater  
**Location:** Hogansville, GA

Argos Ready Mix is pleased to quote the following prices on the above referenced project.

3000 COMM			\$147.00	\ CY
3500 COMM			\$149.50	\ CY
4000 COMM			\$152.50	\ CY
				\ CY
* Environmental			\$7.00	\ Load
* Fuel Surcharge			\$6.00	\ CY
* Add \$4.00 per cubic yard for blended Aggregate				
* Add \$4.00 per cubic yard for straight cement mixes.				
* High-Range Water reducer (HRWR)	add		\$7.00	\ CY
* Mid-Range Water reducer (MRWR)	add		\$5.00	\ CY
* Short load fee less than 6 cu yds		na		\ Load
* Short load Fee less than 4 cu yds		na		\ Load
* Non-Chloride Accelerator	1%	add	\$ 7.00	\ CY
* Non-Chloride Accelerator	2%	add	\$ 14.00	\ CY
* Chloride Accelerator	1%	add	\$ 5.50	\ CY
* Chloride Accelerator	2%	add	\$ 6.50	\ CY
* Retarder		add	\$ 3.00	\ CY
* Synethetic Micro fiber		add	\$7.00	\ CY
* HEATED OR CHILLED WATER		add	\$7.00	\ CY
* Color for concrete please call your local salesman for pricing.				

\*\*For all color concrete a sealer should be used\*\*

\$7/CY PRICE INCREASE AS OF 7/1/23

Opening Fees & Terms

\*Terms: Net 10th

Prices do no include applicable city,state and coounty taxes.  
Normal working hours are Monday thru Friday 7:a.m. to 5:00 p.m.  
The above concrete prices do not have provisions for heating and cooling of the concrete.  
Blockfill: Allowance of 15 minutes per yard to unload after arrival upon job. A charge of  
\$75.00 per hour will assessed after this time.  
Sunday and Holiday charges contact area salesman.  
If you have any questions or need additional prices, please feel free to call me.

Sincerely,

**Jonathan Jones**

Sales

Office 706-884-5621

Mobile 706-881-1905

Fax 706-882-3589

email [jjones@argos-us.com](mailto:jjones@argos-us.com)

CONCRETE & MASONRY SUPPLY

**Estimate**

CMS.REBAR@GMAIL.COM  
 538 SE BROAD ST  
 PO BOX 1598  
 FAIRBURN, GA 30213

Date	Estimate #
9/22/2023	42307

Name / Address
Principle Construction 51 New Hutchinson Mill Rd Lagrange, Ga 30240

Ship To
THE ROYAL THEATER HOGANSVILLE, GA

NOTE: BELOW IS PRICE INCREASE FROM ORIGINAL BID

Project

Description	Qty	U/M	Rate	Total
FABRICATED REBAR REBAR PACKAGE, DIGITAL SHOP DRAWINGS AND DELIVERED TO JOB SITE "BASE BID BUILDING REBAR PACKAGE"	1	ea	920.00	920.00T
FABRICATE REBAR EXTERIOR MASONRY	1	ea	1,700.00	1,700.00T

<b>Subtotal</b>			2,620.00
<b>Sales Tax (7.0%)</b>			183.40
<b>Total</b>			\$2,803.40

# **R&W Welding & Fabricating, Inc.**

**109 Lukken Industrial Drive LaGrange, GA 30240**

September 7, 2023

**RE: Materials Increase at Royal Theater Hogansville, GA**

**Scope of Work:**

**Material, Fabrication, Delivery, and Installation of the following items**

Exterior Fire Stair Rails (23').....	\$3,265.00
Wall Rails for Interior Stairs (140').....	\$ 0.00
Balcony Rails (10').....	\$1,005.00
2 Line Pipe Rails at Left Rear of Bldg.....	\$1,200.00
<b>Total for Materials Increase .....</b>	<b>\$5,470.00</b>

**Note:**

All steel will receive one coat of shop primer (touch up in field will use spray)  
R&W Welding's SOV will include a separate line item for Material Deposits.

**Respectfully Submitted,**

**R&W Welding & Fabricating, Inc.**





# Re-Quote

Date	Quote #
9/27/2023	8736

Name / Address
PRINCIPAL CONSTRUCTION 51 NEW HUTCHINSON MILL RD LAGRANGE, GA 30240

Project Name
ROYAL THEATRE

P.O. No.	Rep
	ML

Qty	Description	Rate	Total
1	Price adjustment for Interior Decorative Wall Features in Theater from original quote in April 2023, ADD:	3,200.00	3,200.00T
		<b>Subtotal</b>	3,200.00T
Make checks payable to: The Sign Store Online, Inc - PO Box 20776 - Macon, GA 31205		<b>Sales Tax (7.0%)</b>	224.00
		<b>Total</b>	3,424.00

Signature \_\_\_\_\_

Date \_\_\_\_\_



**Jeff Lewis**

---

**From:** Johnpaul Cooper <johnpaul4916.cooper@gmail.com>  
**Sent:** Wednesday, September 13, 2023 9:47 AM  
**To:** Jeff Lewis  
**Subject:** Royal Theater phase 2

Jeff, for phase 2 doors and frames. 001, 006, 108d, 108e, 114a, 114b. per the specs **\$2,315 plus tax price increase.**

**Johnpaul Cooper**  
Contract Hardware & Specialty  
Columbus GA 31909  
706-563-0355

**Willingham Sash and Door Co.**

360 7th Street  
 Macon, GA 31201

PO Box 148  
 Macon, GA 31202-0148

To: **PHASE 2 - RE-QUOTE - WOOD DOORS** Date: 9/22/23  
 Attention: Jeff Lewis - Principle Construction Valid Thru: 10/22/23  
 Project Name: Royal Theater Phase 2 Phone:  
 Project Location: Hogansville GA

- \* **It is the purchasers responsibility to review all information. (Quantities, Sizes, Specs, Etc.)**
- \* **Willingham Sash & Door is not responsible for items that are incorrect but ordered according to customer approved documentation**
- \* **All Pricing is plus tax.**
- \* **This quote is limited to items specifically stated within this quote.**
- \* **Does not include: Installation, Finishing, Blocking of Any Kind**

L#	Quan	Unit	Description	Unit	Line
1			Material Increases since original quote		3,000.00
2			Re-Setup Charges		729.00
3					0.00
<b>Drawing Approval Required</b>				Sub Total (Plus Tax)	3,729.00
				Troup Co. Sales Tax	261.03
				<b>Quote Total</b>	<b>3,990.03</b>



*A Clear Difference!*

**TO:** Company: PRINCIPLE CONSTRUCTION

Contact: JEFF

Subject: THE ROYAL THEATER

**FROM:** Rodney Hutto:

E-mail: [rodney@ltrglass.com](mailto:rodney@ltrglass.com)

Phone Number: (706) 653-2288

Fax Number: (706) 653-9030

Date of Transmission: 09/13/23 REVISED

Number of Pages: (2)

I am quoting you on the following:

- 1) Show Drawings will take (4-6) weeks, if required for this project.  
NO Material will be ordered without Approved Shop Drawings!
- 2) The Lead Time for Material (Glass) is 2-4 weeks.  
Alum. Doors & Hardware 4-6 weeks. Storefront 3-6 weeks.  
Fire Rated Glass (12-14 weeks) Quickserv Window 6-8 weeks.
- 3) This Quote will remain valid for a period of 30 Days.  
If not accepted (subcontract) within the 30 days, this proposal will be revised or withdrawal.
- 4) Price is based on sizes, quantities, and specifications as submitted  
any deviation will result in revised pricing.

**EXCLUSIONS:**

- 1) DEMO
- 2) SHOP DRAWINGS
- 3) PE STAMP
- 4) WATER TESTING
- 5) WATER PROOFING
- 6) ACCESS CONTROL
- 7) AUTOMATIC DOOR OPERATOR
- 8) FIRERATED DOORS, FRAMES and GLASS
- 9) MIRRORS

**PLEASE TAKE TIME TO REVIEW THE FOLLOWING MATERIAL BEING FURNISHED.  
IF ITS NOT LISTED BELOW, ITS NOT INCLUDED IN THIS PRICE.**

- 1) KAWNEER
- 2) BLACK FINISH
- 3) 1" GLASS STOP SYSTEM
- 4) ¼" TEMPERED CLEAR GLASS WITH APPLIED FILM

MEETING ROOM #109 WITH 01 - 60" X 48" WOOD OPENING  
MEETING ROOM #110 WITH 02 - 36" X 48" WOOD OPENINGS  
01 - 72" X 48" WOOD OPENING  
OFFICE ROOM #111 WITH 01 - 60" X 48" OPENING

TICKET BOOTH

- a) 01 - QUICKSERV
- b) BLACK FINISH
- c) TI3036 TICKET WINDOW
- d) ¼" CLEAR TEMPERED GLASS
- e) SPEAK HOLE
- f) DEAL TREY

**MATERIAL INCREASE FROM ORIGINAL QUOTE \$1,869**

If you have any questions, please call or email.

Thanks,  
Rodney



**BHE Openings**

3312 Northside Drive  
 Suite D-235  
 Macon, GA 31210

A CUSTOMER FOCUSED DOOR COMPANY

# Estimate

Name / Address

Estimating Dept

Date	Estimate #
7/26/2023	03308

PROJECT NAME
Phase 1

Phone

E-mail

Estimated by Lee Echols  
 lechols@bheopenings.com (478) 841-0012

P.O. No.	Terms	Due Date	Rep	FOB
	To Be Determined	7/26/2023	NLE	Hogansville

Qty	Item	Description	Total
1.00	Hdwe	Attention: Jeff Lewis Project: 2023 Royal Theater Phase 1  GENERAL NOTES / EXCLUSIONS 1) Due to current market conditions, this estimate is only valid for 30 days. 2) RETAINAGE is not acceptable on material purchases. 3) No Payment and Performance Bond included. 4) All installation prices are based on standard working hours of 08:00AM through 05:00PM, Monday through Friday only.  Section: FINISH HARDWARE As per attached hardware schedule	9,210.00T

NOTE: Estimate prices based on purchase of all items listed. Individual prices are subject to change if partial purchase is requested. Estimate is valid for 30 days.

**Subtotal**

**Sales Tax (7.0%)**

**TOTAL**

**HOLLOW METAL DOORS & FRAMES / WOOD DOORS /  
 FINISH HARDWARE / TOILET PARTITIONS &  
 ACCESSORIES / MARKER BOARDS**



**BHE Openings**

3312 Northside Drive  
 Suite D-235  
 Macon, GA 31210

A CUSTOMER FOCUSED DOOR COMPANY

# Estimate

Name / Address

Estimating Dept

Date	Estimate #
7/26/2023	03308

PROJECT NAME
Phase 1

Phone

Estimated by Lee Echols  
[lechols@bheopenings.com](mailto:lechols@bheopenings.com) (478) 841-0012

E-mail

P.O. No.	Terms	Due Date	Rep	FOB
	To Be Determined	7/26/2023	NLE	Hogansville

Qty	Item	Description	Total
1.00	S-Hdwe	Section: METAL DOOR AND WOOD DOOR INSTALLATION - MOBILIZATION #1  BHE labor to swing metal doors and wood doors.  Notes / Exclusions: 1) pricing includes prepping wood doors and wood frames for hinges 2) Any re-sizing of doors to fit frames is excluded. 3) All frames shall be installed by others. 4) No prep work for metal frames or metal doors is included. All metal doors and frames shall be factory prepped by others.	2,415.00
1.00	S-Hdwe	Section: HARDWARE INSTALLATION - MOBILIZATION #2  BHE labor to install hardware listed above.  Notes / Exclusions: 1) Pricing includes prepping wood doors and wood frames for locks and necessary strikes. 2) Any re-sizing of doors to fit frames is excluded. 3) All frames shall be installed by others.	6,720.00

NOTE: Estimate prices based on purchase of all items listed. Individual prices are subject to change if partial purchase is requested. Estimate is valid for 30 days.

<b>Subtotal</b>	\$18,345.00
<b>Sales Tax (7.0%)</b>	\$644.70
<b>TOTAL</b>	<b>\$18,989.70</b>

**HOLLOW METAL DOORS & FRAMES / WOOD DOORS / FINISH HARDWARE / TOILET PARTITIONS & ACCESSORIES / MARKER BOARDS**



**BHE Openings**  
 3312 Northside Drive  
 Suite D-235  
 Macon, GA 31210

A CUSTOMER FOCUSED DOOR COMPANY

# Estimate

Name / Address

Estimating Dept

Date	Estimate #
9/7/2023	03423

PROJECT NAME
Phase 2

Estimated by Lee Echols  
[lechols@bheopenings.com](mailto:lechols@bheopenings.com) (478) 841-0012

Phone

E-mail

P.O. No.	Terms	Due Date	Rep	FOB
	Net 30	10/7/2023	NLE	Hogansville

Qty	Item	Description	Total
1.00	Hdwe	Attention: Jeff Lewis Project: 2023 Royal Theater Phase 2  <hr/> GENERAL NOTES / EXCLUSIONS 1) Due to current market conditions, this estimate is only valid for 30 days. 2) RETAINAGE is not acceptable on material purchases. 3) No Payment and Performance Bond included. 4) All installation prices are based on standard working hours of 08:00AM through 05:00PM, Monday through Friday only. 5) This pricing includes hardware and labor for opening # 002  <hr/> Section: FINISH HARDWARE  As per attached hardware schedule  <hr/>	22,809.94T

<b>HOLLOW METAL DOORS &amp; FRAMES / WOOD DOORS /            FINISH HARDWARE / TOILET PARTITIONS &amp;            ACCESSORIES / MARKER BOARDS</b>	NOTE: Estimate prices based on purchase of all items listed. Individual prices are subject to change if partial purchase is requested. Estimate is valid for 30 days.	<b>Subtotal</b>
		<b>Sales Tax (7.0%)</b>
		<b>TOTAL</b>



**BHE Openings**  
 3312 Northside Drive  
 Suite D-235  
 Macon, GA 31210

A CUSTOMER FOCUSED DOOR COMPANY

# Estimate

Name / Address

Estimating Dept

Date	Estimate #
9/7/2023	03423

PROJECT NAME
Phase 2

Phone

Estimated by Lee Echols

E-mail

[lechols@bheopenings.com](mailto:lechols@bheopenings.com) (478) 841-0012

P.O. No.	Terms	Due Date	Rep	FOB
	Net 30	10/7/2023	NLE	Hogansville

Qty	Item	Description	Total
1.00	S-Hdwe	Section: METAL DOOR AND WOOD DOOR INSTALLATION - MOBILIZATION #1  BHE labor to swing metal doors and wood doors.  Notes / Exclusions: 1) pricing includes prepping wood doors and wood frames for hinges 2) Any re-sizing of doors to fit frames is excluded. 3) All frames shall be installed by others. 4) No prep work for metal frames or metal doors is included. All metal doors and frames shall be factory prepped by others.	2,800.00
1.00	S-Hdwe	Section: HARDWARE INSTALLATION - MOBILIZATION #2  BHE labor to install hardware listed above.  Notes / Exclusions: 1) Pricing includes prepping wood doors and wood frames for locks and necessary strikes. 2) Any re-sizing of doors to fit frames is excluded. 3) All frames shall be installed by others.	10,304.00

<p><i>NOTE: Estimate prices based on purchase of all items listed. Individual prices are subject to change if partial purchase is requested. Estimate is valid for 30 days.</i></p> <p><b>HOLLOW METAL DOORS &amp; FRAMES / WOOD DOORS / FINISH HARDWARE / TOILET PARTITIONS &amp; ACCESSORIES / MARKER BOARDS</b></p>	<b>Subtotal</b>	\$35,913.94
	<b>Sales Tax (7.0%)</b>	\$1,596.70
	<b>TOTAL</b>	<b>\$37,510.64</b>



# WW Acoustical & Drywall LLC

1561 Kendrick Rd. – Milner, Ga. 30257 – 770-891-1992

Date: 09-15-23

Proposal to: Principle Construction

Job Name: Royal Theater

Job Location: Hogansville, Ga.

---

Due to continued market volatility for Gypsum and Metal products, below are the Material price increases for Phase 2 work over and above our previous price quote:

\*Gypsum Products Increase - \$15,349.

\*Metal Furring Hat Channels, Z Channels, and Fasteners Increase - \$19, 816.

**\*Subtotal Increase = \$35,165 + applicable sales tax.**

---

-----SEE PRICES ABOVE-----

---

Any alteration or deviation from above specifications involving extra costs will be executed only upon written orders and will become an extra charge. All agreements contingent upon strikes, accidents or delays beyond our control. This proposal may be withdrawn by us if not accepted within 30 days.

---

Please sign for acceptance of this proposal

---



Sunbelt Rentals Scaffold Services  
723 RALPH MCGILL BLVD NE  
ATLANTA, GA 30312 1122  
(404) 523-5962  
www.sunbeltrentals.com

September 15, 2023 UPDATE - Phase 2

Customer **PRINCIPLE CONSTRUCTION**  
**(606845)**  
*Jeff Lewis*  
7706521954  
*jlewis@principleco.com*

Quote Royal Theatre  
QUO-40208-B4V8C9

Job Site **ROYAL THEATRE**  
L0069BW231935636  
400 E MAIN ST  
HOGANSVILLE, GA 30230 1136

## Introduction

Sunbelt Rentals Scaffold Services ("Sunbelt") is thankful for the opportunity to do business with **PRINCIPLE CONSTRUCTION** ("Customer"). We are happy to support you with a wide variety of installation services for your access needs such as: Frame & Brace Scaffold, System Scaffold, Shoring of Existing Structures, Re-Shoring, Trash Chutes, Scaffold Mounted Hoisting Options, Swing Stage, Man/Material Hoists, Mast Climbers, Interior/Exterior Vessel Access, Stair Towers and Overhead Protection Systems. In addition, we offer various training sets, for your lead men and crews that will apply to each of the products we provide.

We constantly advance the idea of what an equipment rental company can do for its customers, through unmatched customer solutions, uncompromising customer safety, and continuous innovation.

The latest equipment rental technology, more than 900 locations throughout the U.S. and Canada for pick-up or delivery, 550,000 units in our rental fleet, over 15,000 passionate employees with a "make it happen" attitude, and a culture of safety...  
THIS IS THE POWER OF SUNBELT.

Thank you for considering Sunbelt Rentals Scaffold Services,

**Brian Ward**

## Specifications

Temporary Dance Floor Scaffold, Rolling Tower on the Stage

## Scope

---

Sunbelt Rentals will furnish material, labor and supervision to erect and dismantle a temporary dance floor scaffold that will provide access to the ceiling above the seating area in the theatre. The scaffold will be erected on the concrete slab and provide a work area of approx. 3,452 Square feet. The scaffold will include all necessary handrails, toe boards, bracing and ladder access.

Sunbelt Rentals will furnish material, labor and supervision to erect and dismantle a temporary tolling tower on the stage. 7' x 7' decked at approx. 20' high.

## Customer Responsibility

---

Return an executed copy of this quote along with a PO number (for tracking purposes ONLY-no terms) prior to the commencement of any labor associated with this job.

Have a customer representative on-site to sign off with the acceptance of the equipment and upon the completion of the build that it is to their satisfaction.

Customer shall be responsible for daily inspections after initial Sunbelt inspection.

Customer shall notify Sunbelt IMMEDIATELY if any possible damages have occurred to the scaffold that would affect the structural integrity.

Customer agrees to the following:

- Customer shall have all work permits in place prior to Sunbelt's arrival.
- Customer to provide a minimum of two-week's notice for scheduling of any labor phase.
- Customer shall maintain awareness of scaffold load capacities provided by Sunbelt.
- Customer shall provide all necessary floor protection (as applicable).
- Customer shall provide a barricade around the work area prior to Sunbelt's arrival on-site.
- Customer shall remove any obstructions from the scaffold work area.
- Customer shall provide a dedicated lay-down area for scaffold equipment prior to Sunbelt's arrival.
- Customer shall provide a clear and direct passageway from lay-down area to scaffold site.
- Customer shall be responsible for unloading/loading the truck of equipment and placing equipment in the location where the scaffold will be erected.
- Customer is responsible for patching and/or painting all penetration repairs where scaffold was secured to the building.
- Customer shall provide exclusive and interrupted access to elevator during both installation and removal phase of the work.
- Customer accepts that interruption of crane availability shall be as minimal as possible to avoid downtime which may result in a Time and Material charge in addition to this quote (as applicable).
- Customer shall provide logistics for efficient crane load-in upon delivery (as applicable).
- Customer shall provide the crane's maximum capacity for hoisting to required radius (as applicable).
- Customer shall provide signal man for hoisting & crane operation (as applicable).

## General

---

Scaffold will be designed and constructed to meet OSHA 29 CFR Part 1926 Subpart L.

A final job site survey must be completed before a final price can be provided. Additional charges may apply due to changes in logistical conditions, or differences between what is specified in the scope of work and the actual work that needs to be done.

Prices quoted are for working regular time, 7:00 am to 4:00 pm Monday thru Friday. Any time worked outside of regular time, unless pre-approved and in writing, will be charged at the overtime rate of \$75 per man hour.

Delays caused by the customer or the owner of the building will be billed to the customer at the overtime rate.

Rental Protection Plan (RPP) may be charged and added to the total unless waived. RPP is optional coverage that protects against theft, incidental damage, accidental damage and rental liability for bulk and serialized equipment (please see RPP brochure for coverages and additional information). The cost for RPP is 7% of the rental rate for bulk equipment and 15% of the rental rate for serialized equipment.

This quote must be signed and approved before a crew can be scheduled to perform the work. Any subcontracts issued for this project, or purchase orders containing indemnification clauses will have to be approved by Sunbelt before work can begin. Any subcontracts issued after work has started will not be accepted and Sunbelt's terms and conditions will govern the scaffold on the project. This Quote supersedes any and all previous quotes (written or verbal), notes, comments, or advice.

### \*Explanation of Move Charges

---

No moves are included in this proposal.

### \*\*Explanation of Misc. Charges

---

Safety consumables

**Freight quoted below is not inclusive of Transportation Surcharge which will be calculated utilizing combination of the variable and fixed components.** Sunbelt offers transportation services to our customers through knowledgeable professionals via a fleet of trucks and trailers that provide timely delivery of the wide variety of rental equipment that Sunbelt offers. This transportation surcharge is added to each transportation charge, for the transportation services requested by the customer. The transportation surcharge is our charge intended to defray a wide range of transportation expenses (both direct and indirect), which are not always fully recovered by other transportation charges.

**Pricing Details**

<b>Equipment Rental: (4 week min.)</b>	<b>\$3,738.72*</b>
<b>Daily Rental: (after initial 4 weeks)</b>	<b>\$166.80*</b>
<b>Erection Price:</b>	<b>\$15,658.50*</b>
<b>Dismantle Price:</b>	<b>\$10,439.00*</b>
<b>Move Price: (see above)</b>	<b>\$0.00*</b>
<b>Misc./Sales: (see above)</b>	<b>\$275.00*</b>
<b>RPP Included?:</b>	<b>No</b>
<b>Rental Protection Plan:</b>	<b>\$0.00*</b>
<b>Freight: (P/U-Del)</b>	<b>\$800.00*</b>

**Quote Total:**

**\$30,911.22\***

**\*Plus applicable taxes**

**Note: This is a \$6,638.00 Increase in Rental, Erection, Dismantle, and Freight Charges since Initial Quote, plus applicable taxes.**

**Terms & Conditions**

**Terms and Conditions**

**PROJECT CONTRACT SPECIFICATIONS** (a) Customer must be present at time of delivery to sign, inspect, count, and accept responsibility of equipment via Sunbelt Erection Inspection Checklist; (b) If Customer dismantles equipment, any equipment missing is Customer's responsibility and will be charged at replacement cost; (c) Should PE Stamped Drawings be required, additional charges apply. All such engineering work is limited to the Scaffold Design and Leg Loads and does not include analysis of job site structures; (d) Price herein assumes Sunbelt shall be exempted from participating in OCIP/CCIP requirements. If not exempted, additional charges apply; (e) Our quoted price is based on the written terms of this Quote. If we are requested to sign an agreement you prepare, this Quote in its entirety or, must be incorporated into that agreement. If there is a conflict between your agreement and the written and included terms of our Quote, the terms of our Quote shall govern; (f) Both parties shall accept this Quote within 30 days of Date of Quote (above) or it may, at our option, be considered null and void; (g) it is a condition precedent to work being scheduled that this Quote is signed and received by the Scaffold Services Branch listed below; (h) Allow two (2) week lead times for scheduling all labor phases. (i) All work will be performed during straight time hours on day shift, Monday through Friday 7:00 am to 3:30 pm, unless specifically noted otherwise; (j) All work beyond the scope of work outlined above will be reimbursed based on Sunbelt Rentals, Inc. current Man-Hour Rates. These rates shall be made available upon request. The Customer will be responsible for verifying all time sheets. Delays (over 30 minutes), remobilizations, and unacceptable work conditions not attributable to Sunbelt, will be charged at the current Man-Hour Rates and may include a 4-hour minimum and/or additional travel time charges; (k) Scaffolds to be erected to meet or exceed OSHA 1926.451 Subpart L (or as indicated herein).

**SCAFFOLD PRICE EXCLUSIONS.** The pricing of this Quote does not include the following, unless specifically described on the front of this Quote: (a) expenses incurred if the Customer's or the Job Site Physical Address safety requirements exceed State and Federal codes; (b) toeboards, screens and nets; (c) costs associated with providing a firm, compacted and level grade for all scaffolding; (d) any foundations or re-shoring required below sidewalk level or sub-basement level; (e) tarps or other sheeting (scaffolding must be modified to withstand the additional wind loads, with such sheeting); (f) any costs for proof of drug testing or employment drug screening whether it be pre-employment, site required, or otherwise; (g) moving rolling towers; (h) lodging, meals, travel, transportation, or other extraordinary expenses; (i) performance bond, and/or OCIP/CCIP requirements, if required; (j) sales taxes, use taxes, or tariffs; (k) sealed shop drawings or PE Stamped Drawings, if required; and (l) any other costs incurred due to the Job Site Physical Address conditions, delays, or safety considerations not attributed to Sunbelt will be invoiced to Customer on a time and material basis.

**CUSTOMER RESPONSIBILITIES.** Unless otherwise noted herein, Customer shall be responsible for the following, all at Customer's sole expense: (a) compliance with all laws and regulations related to the proper possession and use of scaffolding; (b) provide qualified, experienced, and adequate supervision of any and all users of the scaffolding including a competent person; (c) provide all training of all users as required by 29CFR1910, 29CFR1926, and other applicable local, state, and federal governing bodies, and all accepted industry standards; (d) all scaffold users have read and understand the Codes of Safe Practices; (e) provide a firm, compacted and level grade for all scaffolding; (f) provide suitable crane and forklift support, or other material handling, as needed for the Work; (g) verify that the existing structure will safely support the additional vertical and horizontal loading from the scaffold; (h) repair all holes in existing structure left as a result of concrete anchors or other ties necessary to stabilize scaffold structure; (i) arrange with the Utilities Authority for all necessary safeguards, notifications and process lock-outs prior to erection date; (j) provide electric power and lighting to suit Sunbelt requirements; (k) supply any necessary flagmen or temporary barriers or signs, etc.; (l) if Sunbelt will be working in the vicinity of water, necessary boatmen and boat as defined in OSHA regulations; (m) any ground protection, i.e. for furniture, machines, carpets, landscaping, etc.; (n) toilets and wash facilities; (o) a firm, compacted and level grade laydown yard during both erection and dismantling; (p) security of Sunbelt equipment and materials within laydown yard; (q) restoration of the laydown yard following completion of the Work; (r) all permits; (s) Falling Object Protection and any citations and/or fines OSHA may impose for failure to do so; (t) Customer's fall protection systems and methods during the use of the scaffolding that comply with all laws and be at Customer's risk; (u) assume all risks associated with the possession, custody and operation of and full responsibility for, the equipment, including but not limited to, personal injury, death, rental charges, losses, damages and destruction, including customer transport, loading and unloading; and (v) maintain general and auto liability insurance of not less than \$2,000,000 per occurrence, including coverage for Customer's contractual liabilities herein (such as the indemnification clause); property insurance against loss by all risks to the Equipment, in an amount at least equal to the fair market value thereof; and worker's compensation insurance. Such policies shall be primary (and not on an excess basis), on an occurrence basis, name Sunbelt as an additional insured and loss payee. Customer shall provide Sunbelt with certificates of insurance evidencing the coverage required above prior to any rental and any time upon Sunbelt's request.

**SCAFFOLD CONDITIONS AND ASSUMPTIONS.** Unless otherwise specified herein to the contrary: (a) the scaffolding will be erected and dismantled one time only; (b) any alterations not described herein will be charged at the applicable time and material rates; (c) any overtime work shall be invoiced at the applicable time and material rates; and (e) the work performed by Sunbelt will be done in accordance with applicable state and federal codes.

**INDEMNIFICATION.** Sunbelt indemnifies, releases, defends, and holds Customer harmless from and against any third-party claims including any and all liabilities, losses, damages, claims, penalties, fines and expenses, including attorney's fees, for any damages to property and/or persons including death ("Claims") to the proportionate extent caused by Sunbelt or any of its contractors, suppliers, officers, agents, or employees negligent acts or omissions in the performance of this Agreement. Customer will (i) give Sunbelt prompt notice of any such Claim, and (ii) at Sunbelt's reasonable request, cooperate with Sunbelt in the defense and settlement of the Claim. Customer indemnifies, releases, defends and holds Sunbelt harmless from and against any third-party claims including any and all Claims to the proportionate extent caused by Customer's or any of its contractors, suppliers, officers, agents, or employees negligent acts or omissions in the performance of this Agreement. Sunbelt will (i) give Customer prompt notice of any such Claim, and (ii) at Customer's reasonable request, cooperate with Customer in the defense and settlement of the Claim. Notwithstanding anything contained in any agreement between the parties to the contrary, Sunbelt's requirement to provide additional insured, primary, noncontributory and waiver of subrogation status shall be limited to the extent of Sunbelt's indemnification obligations herein.

**SCAFFOLD CHANGE ORDERS.** If Customer requests a change in the Work, Sunbelt shall send Customer's "Point of Contact" a change order request in written form. Customer shall return a signed copy of the change order to Sunbelt; provided however, if no objection to the change order is received by Sunbelt, the change order shall be deemed approved by Customer.

INSPECTION AND ACCEPTANCE. On Customer's acceptance of the erected scaffold, Customer will be responsible for the maintenance, control, proper use and supervision of the scaffold until such time as the scaffold is fully dismantled and returned to Sunbelt for removal from the Job Site.

OTHER TERMS. The remaining provisions of this Quote are shown on the following page and incorporated herein by reference and can also be found at: <https://www.sunbeltrentals.com/solutions/scaffold-services/terms-and-conditions/>

**Quote Acceptance**

---

**PRINCIPLE CONSTRUCTION**

*Jeff Lewis*

\_\_\_\_\_  
Acceptance Signature of Customer's Authorized Representative

\_\_\_\_\_  
Date

**Sunbelt Rentals, Inc.**

***Brian Ward***

\_\_\_\_\_  
Acceptance Signature of Sunbelt Rentals Authorized Employee

\_\_\_\_\_  
Date



**SUNBELT**  
RENTALS®



9314 8898 8030 0070 9087 04

Construction Notice Department  
PO Box 1389, Simi Valley, CA 93062

*Address Service Requested*

10/23/2023

SBR999 12981735

CITY OF HOGANSVILLE  
111 HIGH STREET  
HOGANSVILLE, GA 30230

**IMPORTANT NOTICE PLEASE READ CAREFULLY  
THIS IS NOT A LIEN**

Enclosed you will find a notice that is being sent to you on behalf of Sunbelt Rentals, Inc. in regards to the construction project known as ROYAL THEATRE and located at 400 E MAIN ST , HOGANSVILLE, GA 30230 1136. PO # L2316-14.800.. The name the person or company who contracted for the furnishing of equipment is 606845, PRINCIPLE CONSTRUCTION.

**It is important to note this notice and the amount listed is sent in order to comply with certain state requirements that may exist and should not reflect in any way on the integrity or credit standing of any of the known interested parties associated with this job.**

If an amount is reflected on this notice, it is the total invoiced amount for all invoiced services as of the date of this notice, however the amount reflected may not be due at this time depending on payment terms.

The notice is merely a letter informing the owner of the property and/or general contractor that Sunbelt Rentals, Inc. has supplied or will supply services, equipment and/or materials. Failure to ensure that their vendor is paid may result in a lien being placed on your property and you're paying twice for the materials and/or services provided to you by the vendor listed this notice. If you have paid or are about to pay your contractor, ask them for a Release of Lien to ensure their vendor is paid at [lienrelease@sunbeltrentals.com](mailto:lienrelease@sunbeltrentals.com)

We have attempted to verify the project's information prior to sending this notice. If there is a payment bond related to the improvements or documents relating to the work of improvement being ordered by a lessee/tenant, this is a formal request by Sunbelt Rentals, Inc. for a copy of said documents. If any of the information contained in this notice is incorrect, or you are not associated with this job, please contact us immediately at [Notices@SunbeltRentals.com](mailto:Notices@SunbeltRentals.com)

If you require information regarding contractor payment status, please contact Sunbelt Rentals, Inc. at 800-508-4756 ext. 4435.

**NOTICE TO CONTRACTOR - PUBLIC PROJECT**  
**(Ga. Code Ann. §§ 13-10-63(a)(2) and 36-91-93(a)(2))**

TO: THE OWNER: CITY OF HOGANSVILLE, 111 HIGH STREET, HOGANSVILLE GA 30230.

TO: CONTRACTOR: PRINCIPLE CONSTRUCTION, 51 NEW HUTCHINSON MILL RD, LAGRANGE, GA 30240.

TO: CONSTRUCTION LENDER: ATLANTIC SPECIALTY INSURANCE COMPANY, 605 HIGHWAY 169 NORTH SUITE 800, PLYMOUTH, MN 55441.

PLEASE TAKE NOTICE that the undersigned is providing certain labor, services, materials or equipment to your project set forth below:

1. The name, address and telephone number of the person providing labor, services, materials or equipment: Sunbelt Rentals, Inc. 1275 West Mound Street Columbus, OH 43223 Ph: 800-508-4756.
2. The name and address of each interested party at whose instance the labor, services, materials or equipment is being furnished: PRINCIPLE CONSTRUCTION, 51 NEW HUTCHINSON MILL RD , LAGRANGE, GA 30240.
3. The name of the public project and location of the project project as set forth in the Notice of Commencement: L0069BW231935636, ROYAL THEATRE 400 E MAIN ST , HOGANSVILLE, GA 30230 1136.
5. If known, the contract price or anticipated value of the labor, materials, machinery or equipment to be provided, or amount claimed to be due, if any: \$20,545.64.

REQUEST FOR NOTICE OF COMMENCEMENT (NOC) PURSUANT TO SECTION 44-14-361.5 of the Georgia Statutes: Please deliver a copy of the NOC to CRF Solutions at P.O. Box 1389 Simi Valley, CA 93062, or fax to 805-522-7171, or email to myjobinfo@crfsolutions.com within 10 days of receipt of this notice and please reference the CRF# below in all communications.

Dated: 10/23/2023

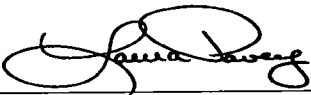
By:   
Laura Pavey / CRF Solutions  
Authorized Agent For:  
Sunbelt Rentals, Inc.

**PROOF OF SERVICE BY MAIL AFFIDAVIT**

I declare that I served a copy of the above document, and any related documents, by (as required by law) first-class, certified or registered mail, postage prepaid, addressed to the above named parties, at the addresses listed above, on 10/23/2023. I declare under penalty of perjury that the foregoing is true and correct. Executed at Simi Valley, CA on 10/23/2023.

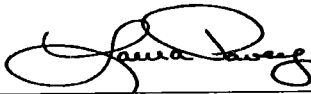
By:   
Laura Pavey / CRF Solutions

Cert #: 9314 8898 8030 0070 9087 04  
CRF#: 12981735



# Quotation

**MERNA PAINTING SOUTHEAST, INC.**

**Company Address**

212 New Airport Road LaGrange, GA 30240  
 Phone: 706-883-8903 Fax: 706-882-8820

**Date** 9/21/2023

**Quotation #** 061323-1

**Customer ID** theater

**Quotation For**

Jeff Lewis  
 Principle Constuction  
 51 New Hutchinson Mill Rd,  
 LaGrange,GA 30240

**Quotation valid until** 10/21/2023

**Prepared by** Spencer Merna

**Terms** Net 30

**Comments or Special Instructions**

Royal Theater \*\*Phase 2\*\* Price Increase  
 This quote includes all labor, materials, equipment and supervision unless otherwise noted.

Quantity	Description	Unit Price	Taxable?	Amount
1	Materials price Increase for specified Water Repellants and Bituminous Dampproofing for sealing interior brick and exterior brick and stucco.	\$ 4,387.00		\$ 4,387.00
1				

**Subtotal** \$ 4,387.00

**Tax Rate**

**Sales Tax** \$ -

**Other**

**TOTAL** \$ 4,387.00

If you have any questions concerning this quotation, please contact:  
 Spencer Merna - Cell 706-616-0489

We Appreciate the Opportunity to Quote This Work!



# Re-Quote

Date	Quote #
9/20/2023	8687

Quote Valid for 10 Days  
Steel Quote Valid for 5 Days

Name / Address
PRINCIPAL CONSTRUCTION 51 NEW HUTCHINSON MILL RD LAGRANGE, GA 30240

Project Name
ROYAL THEATRE

P.O. No.	Rep
	ML

Qty	Description	Rate	Total
1	<p>TWO SINGLE SIDED INTERNALLY LIGHTED SIGN CABINETS 11' 8" WIDE X 3' 6" TALL X 8" DEEP. ALUMINUM FRAMED WITH .063 SKIN AND FLAT WHITE POLYCARBONATE FACE WITH CHANGEABLE COPY TRACK FOR FOUR LINES OF 6" CHANGEABLE COPY LETTERS. TWO LINES OF BLUE NEON TUBING AROUND FACE OF CABINET. WHITE LED LIGHTS WITH 5 YEAR PARTS WARRANTY.</p> <p>ONE SINGLE SIDED NON ILLUMINATED CABINET 20' LONG, X 3' 6" TALL X 8" DEEP. ALUMINUM FRAMED WITH .063 SKIN AND .063 FACE. TWO LINES OF BLUE NEON TUBING AROUND FACE OF SIGN. WHITE NON ILLUMINATED GRAPHICS TO SPELL ROYAL APPLIED FIRST SURFACE WITH BLUE NEON BORDER FOR EACH LETTER.</p> <p>ONE DOUBLE SIDED 20' LONG X 4' WIDE X 12" DEEP CUSTOM ROUTED NON ILLUMINATED SIGN CABINET WITH DECORATIVE TOP AND BOTTOM. ALUMINUM FRAME WITH .063 ALUMINUM SKIN. TWO 12' LONG MOUNTING BRACKETS TO ATTACH TO BUILDING. WHITE NON ILLUMINATED GRAPHICS TO SPELL ROYAL OF EACH SIDE WITH BLUE NEON BORDER FOR EACH LETTER. TWO LINES OF BLUE NEON TUBING AROUND EACH FACE WITH THREE NEON PIECES TOP AND BOTTOM</p>	65,801.00	65,801.00T
		<b>Subtotal</b>	
<p>Make checks payable to: The Sign Store Online, Inc - PO Box 20776 - Macon, GA 31205</p>		<b>Sales Tax (7.0%)</b>	
		<b>Total</b>	

Signature \_\_\_\_\_

Date \_\_\_\_\_



# Re-Quote

Date	Quote #
9/20/2023	8687
Quote Valid for 10 Days Steel Quote Valid for 5 Days	

Name / Address
PRINCIPAL CONSTRUCTION 51 NEW HUTCHINSON MILL RD LAGRANGE, GA 30240

Project Name
ROYAL THEATRE

P.O. No.	Rep
	ML

Qty	Description	Rate	Total
1	<p>THIS INCLUDES TWELVE (12) 15,000 SERVICE MASTER SELF ADJUSTING TRANSFORMERS FOR NEON . ALL NEON CONNECTIONS HAVE RUBBER BOOTS TO COVER WIRES. TRANSFORMERS AND NEON HAVE A 12 MONTH WARRANTY FOR WORKMANSHIP. EXPOSED NEON IS FRAGILE AND IS NOT WARRANTED FOR DAMAGE FROM FOREIGN OBJECTS, BIRDS OR ACTS OF GOD.</p> <p>INSTALLATION INCLUDES TWO CREWS AND TWO TRUCKS TO INSTALL THREE SINGLE SIDED SIGN CABINETS, CONNECT TO EXISTING POWER AND INSTALL ONE DOUBLE SIDED BLADE SIGN AND CONNECT TO EXISTING POWER. BUILDING WILL NEED BLOCKING BEHIND WALL TO SUPPORT THE BLADE SIGN. PRICE INCLUDES TRAVEL, PER DIEM AND FUEL CHARGES.</p> <p>50% DEPOSIT REQUIRED WITH APPROVED DRAWINGS BEFORE WORK CAN BEGIN. PRODUCTION FOR THIS PROJECT IS APPROXIMATELY 8 WEEKS FROM APPROVALS. PRICE DOES NOT INCLUDE RUNNING ELECTRICAL POWER TO SIGN SITE OR PROVIDING THE CANOPY OR FRAME FOR SUPPORTING THE CABINETS.</p>	11,100.00	11,100.00

<b>Subtotal</b>		\$76,901.00
-----------------	--	-------------

Make checks payable to: The Sign Store Online, Inc - PO Box 20776 - Macon, GA 31205		<b>Sales Tax (7.0%)</b> \$4,606.07
----------------------------------------------------------------------------------------	--	------------------------------------

<b>Total</b>		\$81,507.07
--------------	--	-------------

Signature \_\_\_\_\_ Date \_\_\_\_\_

## Jeff Lewis

---

**From:** Mitch Kernodle <mitch@eagleriverforge.com>  
**Sent:** Wednesday, October 4, 2023 12:30 PM  
**To:** Jeff Lewis  
**Subject:** RE: The Royal Theater

Jeff,  
I have \$8,750. for crane, neon, roof prep, and install.  
Lightning protection has not gotten back to me yet. I hate to venture into that but 5k looks to be average.

**From:** Jeff Lewis <jlewis@principleco.com>  
**Sent:** Tuesday, October 3, 2023 1:43 PM  
**To:** Mitch Kernodle <mitch@eagleriverforge.com>  
**Subject:** FW: The Royal Theater

Afternoon Mitch.  
Just checking back with you on this.  
Did you finalize your pricing?

**Jeff Lewis**  
Sr. Project Manager



mobile 770.652.1954 | office 706.407.2525  
[www.PrincipleCo.com](http://www.PrincipleCo.com) | GEORGIA | ALABAMA

**From:** Jeff Lewis  
**Sent:** Tuesday, September 26, 2023 4:35 PM  
**To:** Mitch Kernodle <mitch@eagleriverforge.com>  
**Subject:** RE: The Royal Theater

No, I haven't rented a Crane in several years.

Call John Tarver(706-249-1754) at TNT Structures and tell him you are pricing something for me and I'm sure he can give you names for couple Crane Co., John is a steel erector in Pine Mountain I work with a lot.

**Jeff Lewis**  
Sr. Project Manager



mobile 770.652.1954 | office 706.407.2525  
[www.PrincipleCo.com](http://www.PrincipleCo.com) | GEORGIA | ALABAMA

# West Georgia Fire Extinguisher, Inc.



770 Kingsbridge Road • Carrollton, GA 30117

(770) 836-0578 • Fax: (770) 830-8448

www.westgeorgiafire.com



## Estimate

<b>CONTRACTOR</b>
Principle Construction
Phase 1

Date	Estimate #
6/7/2023	914-25613

Terms	FOB
Net 30	Jobsite

Description	Qty	Cost	Total
Cosmic 10E - JL Ind Fire Extinguisher, 10 lb ABC Dry Chemical, UL Rated 4A80BC, Fully Charged & Tagged, Complete with Mounting Bracket.	3	69.85	209.55
1037V17 - JL Ind Model Cosmopolitan Fire Extinguisher Cabinet, Semi Recessed, Rolled Edge Trim, #4 Stainless Steel Door & Trim, Vertical Duo Tempered Glass Door, Black Vertical <u>Engraved Letters "Fire Extinguisher"</u> , <u>NON RATED</u>	3	336.60	1,009.80
Approximate Freight Charge to Jobsite For Entire Shipment		195.00	195.00
* ALL FIRE EXTINGUISHERS ARE PROPERLY TAGGED PER STATE OF GA. REQUIREMENTS			
** THE ABOVE QUANTITIES ARE OUR ESTIMATE ONLY AND SHOULD BE VERIFIED. IF NECESSARY PLEASE USE UNIT PRICES WHEN TABULATING YOUR BID			
Troup County Sales Tax 7%		99.00	99.00
WE WILL HOLD PRICES FIRM AS LONG AS POSSIBLE, HOWEVER, WE HAVE BEEN ADVISED BY THE MANUFACTURER THAT DUE TO FLUCTUATING MARKET CONDITIONS, PRICES ARE FIRM FOR 60 DAYS ONLY AND SUBJECT TO CHANGE WITHOUT NOTICE			

PROJECT - THE ROYAL THEATER - HOGANSVILLE, GA	<b>Total</b>	\$1,513.35
-----------------------------------------------	--------------	------------

*David S. Lyle*

# West Georgia Fire Extinguisher, Inc.



770 Kingsbridge Road • Carrollton, GA 30117

(770) 836-0578 • Fax: (770) 830-8448

www.westgeorgiafire.com



## Estimate

<b>CONTRACTOR</b>
Principle Construction
Phase 2

Date	Estimate #
6/7/2023	914-25613

Terms	FOB
Net 30	Jobsite

Description	Qty	Cost	Total
Cosmic 10E - JL Ind Fire Extinguisher, 10 lb ABC Dry Chemical, UL Rated 4A80BC, Fully Charged & Tagged, Complete with Mounting Bracket.	3	69.85	209.55
1037V17 - JL Ind Model Cosmopolitan Fire Extinguisher Cabinet, Semi Recessed, Rolled Edge Trim, #4 Stainless Steel Door & Trim, Vertical Duo Tempered Glass Door, Black Vertical <u>Engraved</u> Letters "Fire Extinguisher". <u>NON RATED</u>	3	336.60	1,009.80
Approximate Freight Charge to Jobsite For Entire Shipment		195.00	195.00
* ALL FIRE EXTINGUISHERS ARE PROPERLY TAGGED PER STATE OF GA. REQUIREMENTS			
** THE ABOVE QUANTITIES ARE OUR ESTIMATE ONLY AND SHOULD BE VERIFIED. IF NECESSARY PLEASE USE UNIT PRICES WHEN TABULATING YOUR BID			
Troup County Sales Tax 7%		99.00	99.00
<p>WE WILL HOLD PRICES FIRM AS LONG AS POSSIBLE, HOWEVER, WE HAVE BEEN ADVISED BY THE MANUFACTURER THAT DUE TO FLUCTUATING MARKET CONDITIONS, PRICES ARE FIRM FOR 60 DAYS ONLY AND SUBJECT TO CHANGE WITHOUT NOTICE</p>			

PROJECT - THE ROYAL THEATER - HOGANSVILLE, GA	<b>Total</b>	\$1,513.35
-----------------------------------------------	--------------	------------

*David S. Lyle*



# Re-Quote

Date	Quote #
9/27/2023	8735

Name / Address
PRINCIPAL CONSTRUCTION 51 NEW HUTCHINSON MILL RD LAGRANGE, GA 30240

Project Name
ROYAL THEATRE

P.O. No.	Rep
	ML

Qty	Description	Rate	Total
1	Price adjustment for Aluminum Canopies from original quote in April 2023, ADD:	3,700.00	3,700.00T
		<b>Subtotal</b>	3,700.00T
Make checks payable to: The Sign Store Online, Inc - PO Box 20776 - Macon, GA 31205		<b>Sales Tax (7.0%)</b>	259.00
		<b>Total</b>	3,959.00

Signature \_\_\_\_\_

Date \_\_\_\_\_



1075 MOUNTVILLE HOGANSVILLE ROAD  
HOGANSVILLE GA 30230  
706 523-2661/mcsheatingandair.net  
mcsheatingandair@gmail.com  
*Your Comfort Is our Business*

9/13/2023

Attn: Mr. Brent Conrad  
Principle Construction

Thank you for the opportunity to provide you with the mechanical bid for the Royal Theater in Hogansville Georgia.

Units ACU-3, EF-5, EF-6 as part of Phase 2 work will increase by \$4,417.00 from original pricing sent on 4/11/2023.

This will include all materials and labor to perform described work according to the plans. This also includes meeting all local, state and federal codes.

Thank you again for the opportunity to bid this project.

Kindest Regards



Date: Sept 18, 2023

RE-Quote



Allison Phillips  
Lighting Specialist  
Atlanta Projects Department  
293 Swanson Dr.  
Lawrenceville, Georgia 30043  
Tel, 678-627-3344  
alison.phillips@cityelectricsupply.com |  
www.cityelectricsupply.com

**Project** THE ROYAL THEATER  
**Location** HOGANSVILLE GA

**Price increase for Phase 2 Lights, not included in changes per Revision #4.**

**To: IDEAL ELECTRIC**

**For**  
**Bid Date** Jun 20, 2023  
**Expires** Jul 20, 2023  
Architect: Dunwoody Beeland Architects  
Engineer: Electrical Design Consultants - Augusta

Type	MFG	Part
A	ABL	LDN6 35/10
B	GLIG	GL 2533 LED16 E PAB
C	ABL	2BLT4 48L ADSM GZ10 LP835
C2	ABL	2BLT2 33L ADSM GZ10 LP835
D	ABL	LDN6 35/20 LO6AR LD MVOLT GZ10
E	OCL	FRI S1SC 13 ** BMP LED2 35K UNV DM1
F	ABL	10CRM4L LLP 4FT MSL4 80CRI SSH 35K I1000LMF 1000LMF MIN1 ZT MVOLT SCT F1/** C110 <b>Line Note:</b> 4' UNIT
G	ABL	WL4 40L GZ10 LP835
H	ABL	LDN6 35/50 LO6AR LD MVOLT GZ10
J	ABL	CSS L48
T	LSI	STANDARD TRACK PER FOOT <b>Line Note:</b> PER FOOT
T	LSI	LX2084-T19-50-83-30K-J3-00-TE-120V-B
T	LSI	MISC FEED
OA	ABL	LDN6 40/20 LO6AR LD MVOLT GZ10
OB	ABL	TWX1 LED ALO 40K MVOLT DDBTXD
OC	ABL	TWX2 LED ALO 40K MVOLT DDBTXD
COMBO	ABL	ECRG RD
EM	ABL	ELM2L
OUTEM	ABL	AFO DB MVOLT N SD <b>LTG CTRLS AS PER SPECS &amp; PLANS - EQUIPMENT &amp; SERVICE</b>
OS1	CTRL	CM PDT 10 R <b>Line Note:</b> Ceiling Mount Sensor, Passive Dual Technology, Large Motion / Extended Range 360 Lens, Isolated Low Voltage Relay
SW3	CTRL	NPOD TOUCH WH <b>Line Note:</b> Low Voltage Wallpod, Touchscreen Wall Control
SW4	CTRL	NPODMA 4S DX WH <b>Line Note:</b> nLight Wired Aesthetic Wallpod, 4 scene control, Raise/Lower Dimming Without Wires



**Project THE ROYAL THEATER**  
**Location HOGANSVILLE GA**

Type	MFG	Part
PP2	CTRL	PP20 <b>Line Note:</b> Power Pack
PS1	CTRL	NPS 80 <b>Line Note:</b> Power Supply, 80 mA
DP1	CTRL	NPP16 D EFP <b>Line Note:</b> Power/Relay Pack, Occupancy Controlled Dimming, External Fault Protection
DP2	CTRL	NSP5 PCD ELV 120 <b>Line Note:</b> Secondary Relay Pack, Phase Control Dimming, Electronic Low Voltage, 120 VAC
SO1	CTRL	WSXA PDT WH <b>Line Note:</b> Wall Switch Sensor, Passive Dual Technology
SW5	CTRL	SPODMA D SA 3X WH <b>Line Note:</b> Wall Switch, Occupancy Controlled Dimming, Vacancy (default) or Auto-On, Multi-Way
SW6	CTRL	SPODMA SA 3X WH <b>Line Note:</b> Wall Switch, Vacancy (default) or Auto-On, Multi-Way
S1	LAI	<b>SERVICES</b> CONTROLS SYSTEM STARTUP

***NO EMERGENCY LTG CONTROL DEVICES ARE INCLUDED  
 LTG CONTACTOR, TIMECLOCK & PE CELL BY OTHERS***

**Total Increase: \$7,338**

This Quotation supercedes all previous quotations and agreements relating to this transaction. Unless otherwise stated on this document: (i) Our quotation for your use in submitting a job or project bid to your customer expires 30 days from the date hereof, and may be withdrawn earlier by us if prior to acceptance of your bid. (ii) All other quotations are subject to price increases in effect through time of shipment.

All sales are subject to City Electric Supply's Terms & Conditions of Sale in effect at the time of the quotation. This quotation supersedes all previous quotations relating to this transaction. Due to market conditions, all products or items set forth in this quotation are subject to price increases through time of shipment unless this quotation expressly states that pricing for any such products or items is firm and fixed. Any services included in this quotation and listed as not being performed by City Electric Supply shall be provided on a pass-through basis with the actual service provider's terms and conditions governing the provision of the services. SHIPPING AND HANDLING AND TAXES NOT INCLUDED

**Lighting storage available upon request, cost determined by job.**





**PRINCIPLE**  
CONSTRUCTION

# Change Order Request

**Project:** The Royal Theater  
400 East Main Street

**COR#:** 02

**To:** City of Hogansville  
111 High Street  
Hogansville, GA 30230

**Date:** 10/9/2023

**Re:** Reroute Existing Sprinkler Main Line

**Description of Change:**

Reroute existing 3" sprinkler main in attic of Theater to accommodate proposed duct design.

**Total Cost**  
**Change in Contract Time**

**ADD** \$8,161  
None

**Attachments:**  Pricing/Breakdown  Other

**Signed By:** [Signature]  
General Contractor

10-9-23

**Date**

**Reviewed By:** [Signature]  
Architect

10-10-23

**Date**

**Approved By:** [Signature]  
Owner

10-16-23

**Date**

Please contact me with any questions that may arise concerning this change order request.



October 10, 2023

Mr. Jeff Lewis  
Principle Construction  
E: [jlewis@principleco.com](mailto:jlewis@principleco.com)

RE: Reroute 3 1/2" Main  
Royal Theatre

Mr. Lewis:  
We request an ADD to *Reroute 3 1/2" Main in High Area* of Royal Theatre.

Scope of Work:

Labor - Cut, Groove, Install Piping & Re-charge System - 40 MH(2men) x \$75/MH = \$3,000.00  
Materials - 3 1/2" schedule 40 elbows, grooved couplings, pipe, shop supplies = \$2,376.00  
Equipment - threading machine for aerial work, small tools, PPE = \$645.50  
Overhead - 5% & Markup - 10% = \$903.50

**Labor, Materials, & Equipment:                      \$ 6,925.00**

Please respond as soon as possible.

Derek Akins  
General Manager

---

Principle Construction

---

Hydrofire, LLC

/sp

1401 Park Lane – P.O. Box 470  
West Point, GA 31833  
P: (706) 643-8790 E: (706) 643-8792  
website: [www.hydrofirellc.com](http://www.hydrofirellc.com)





October 9, 2023

Mr. Jeff Lewis  
Principle Construction  
E: [jlewis@principleco.com](mailto:jlewis@principleco.com)

RE: Reroute 3 1/2" Main  
Royal Theatre

Mr. Lewis:  
We request an ADD to *Reroute 3 1/2" Main in High Area* of Royal Theatre.

**Scope of Work:**

- Cut out a section of 3 1/2" main.
- Groove 3 1/2" pipe in air (2 different places).
- Add (4) 3 1/2" 90's, (8) 3 1/2" grooved couplings, and 3 1/2" schedule 40 pipe.
- Install hangers as needed.
- Daily clean up.

**Labor, Materials, & Equipment:                      \$ 6,925.00**

Please respond as soon as possible.

Derek Akins  
General Manager

---

Principle Construction

---

Hydrofire, LLC

/tp

1401 Park Lane – P.O. Box 470  
West Point, GA 31833  
P: (706) 643-8790 E: (706) 643-8792  
website: [www.hydrofirellc.com](http://www.hydrofirellc.com)

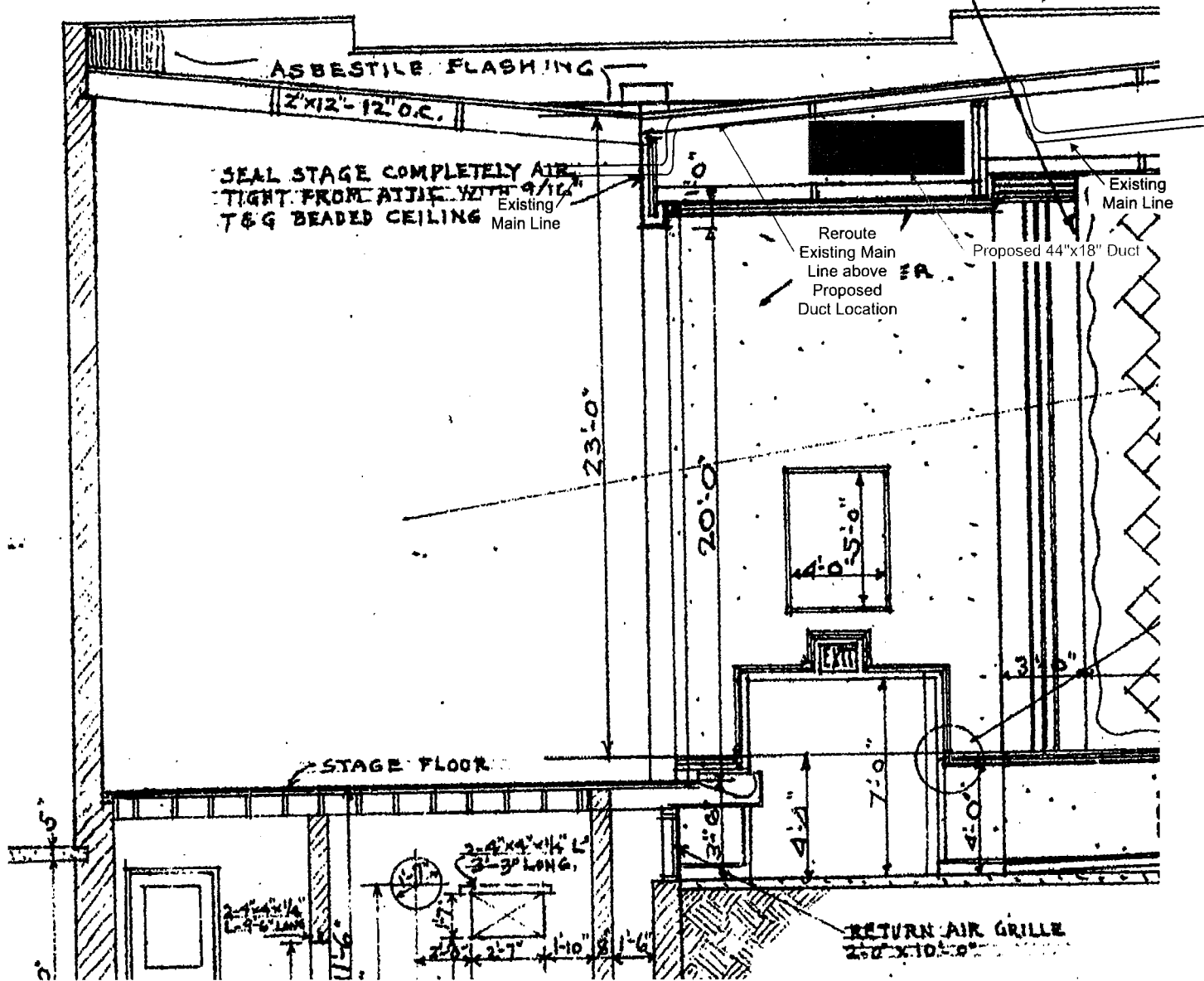







**PRINCIPLE**  
CONSTRUCTION

# Change Order Request

**Project:** The Royal Theater  
400 East Main Street

**COR#:** 03

**To:** City of Hogansville  
111 High Street  
Hogansville, GA 30230

**Date:** 10/12/2023

**Re:** Add Door 101B

**Description of Change:**  
Add Door #101B, per information received from Architect.

**Total Cost** **ADD** \$4,538  
**Change in Contract Time** None

**Attachments:**  Pricing Breakdown  Other \_\_\_\_\_

**Signed By:** [Signature] 10-12-23  
General Contractor **Date**

**Reviewed By:** [Signature] 10/13/2023  
Architect **Date**

**Approved By:** [Signature] 10-16-2023  
Owner **Date**

Please contact me with any questions that may arise concerning this change order request.



# Willingham Sash and Door Co.

## Quote

To:	Date: 9/22/23
Attention:	Valid Thru: 10/22/23
Project Name: Royal Theater Phase 2	Phone:
Project Location: Hogansville GA	

- \* **It is the purchasers responsibility to review all information. (Quantities, Sizes, Specs, Etc.)**
- \* **Willingham Sash & Door is not responsible for items that are incorrect but ordered according to customer approved documentation**
- \* **All Pricing is plus tax.**
- \* **This quote is limited to items specifically stated within this quote.**
- \* **Does not include: Installation, Finishing, Blocking of Any Kind**

L#	Quan	Unit	Description	Unit	Line
1			E Door Slab		
2			E Door Jamb		225.00
3			E Door Trim		105.84
<b>Drawing Approval Required</b>					
				Sub Total (Plus Tax)	330.84
				Troup Co. Sales Tax	23.16
<b>Quote Total</b>					<b>354.00</b>

<b>Job Name:</b> Royal Theater Added Door	<b>Quote Date:</b> 09/22/2023
<b>Manufacturer's Estimated Lead Time:</b> 11-12 Weeks	<b>Account Manager:</b> Manuel (Jay) Becerra

Dealer
Willingham Sash & Door 360 7th St Macon, GA 31201

Customer
Principle Construction 51 New Hutchinson Mill Rd La Grange, GA 30240

Comments
<p>* It is the purchasers responsibility to review all information and return the signed approval drawings. To Include but not limited to: 1) Size 2) Swing 3) Jamb Size 4) Hardware 5) Boring ... Etc.</p> <p>* Willingham Sash &amp; Door is not responsible for items that are incorrect but ordered according to customer approved documentation.</p> <p>* This quote is limited to items specifically contained within the attached quote.</p> <p>* All spec sheets and each door drawing MUST be signed and dated and returned to place the order.</p>

Line	Label	Qty	UOM	Description	Unit	Extended
1	Added Door	1	EA	36 inch X 80 inch, 1 3/4, TS2020, Slab Only, Single, TruStile Interior Poplar (Paint-Grade) Door, CB-Cove and Bead Sticking, C-Flat Panel (1/2")	\$645.46	\$645.46
2		1	EA	Manufacturer's Freight for 1 Door	\$140.00	\$140.00
<b>Total Units:</b>		<b>1</b>			<b>Total:</b>	<b>\$785.46</b>

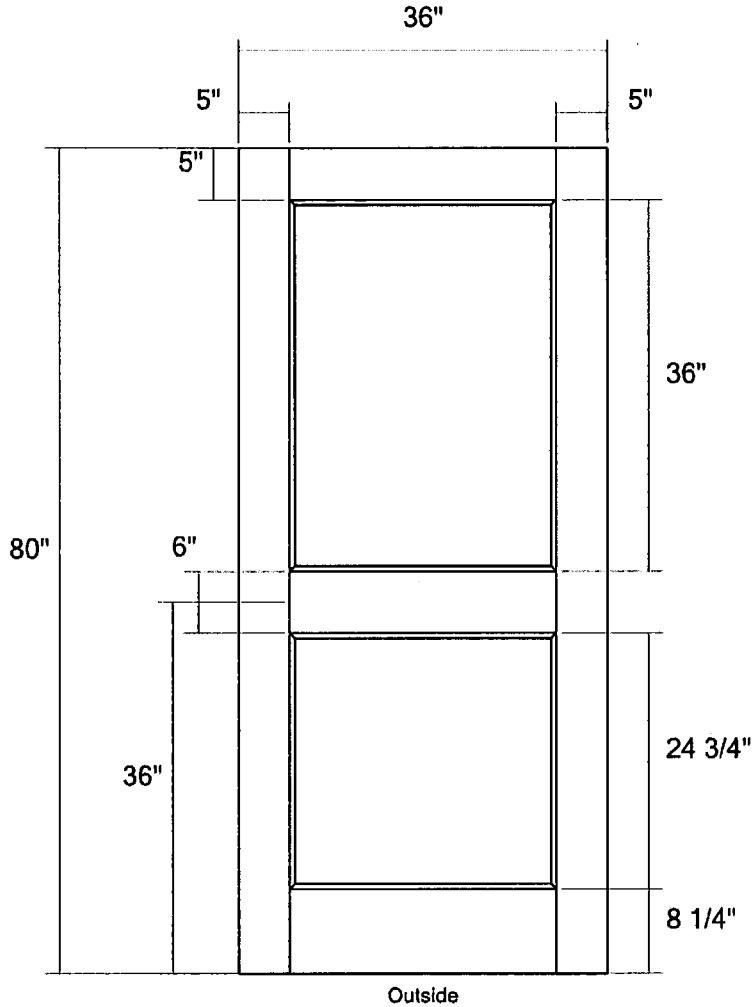

\*All panels have a vertical grain orientation

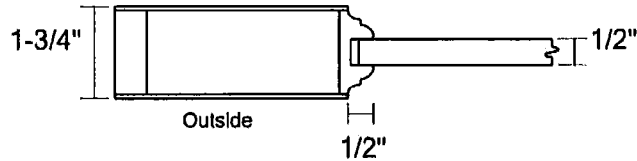

Door Style	Sticking	Panel	Material	Glass	Fire Rating	Grade
TS2020	CB	C	Poplar (Paint-Grade)	N/A	Non-Rated	Interior
Quote #: SQDTP000242-3				Line #: 1 - Added Door		
Willingham Sash & Door				Entered By: Manuel (Jay) Becerra		
Approval (sign here):				Created On: 09/22/2023		



308 James E Williams Industrial Drive  
Byron, GA 31008

# Change Order Proposal

Project: Royal Theater - Phase I and II  
 Contractor: Principle Construction  
 BHE Change Order Proposal # 1  
 BHE Estimate # 03423  
 Rep: Lee Echols  
 Date: 10/12/2023  
 Sales Tax Rate: 7.00%

Description of Change: ADD hardware for new opening 101B

LINE	QUANTITY	DESCRIPTION	UNIT PRICE	TAXABLE?	AMOUNT
1	1	ADD hinges, Panic Device, Closer, Stop for new opening 101B	\$1,518.00	T	\$1,624.26
2	1	ADD labor to install hardware and swing door - door shall be provided by others	\$210.00		\$210.00
			\$0.00		\$0.00
			\$0.00		\$0.00
			\$0.00		\$0.00
			\$0.00		\$0.00
			\$0.00		\$0.00
			\$0.00		\$0.00
			\$0.00		\$0.00
<b>TOTAL CHANGE ORDER</b>					<b>\$1,835.00</b>

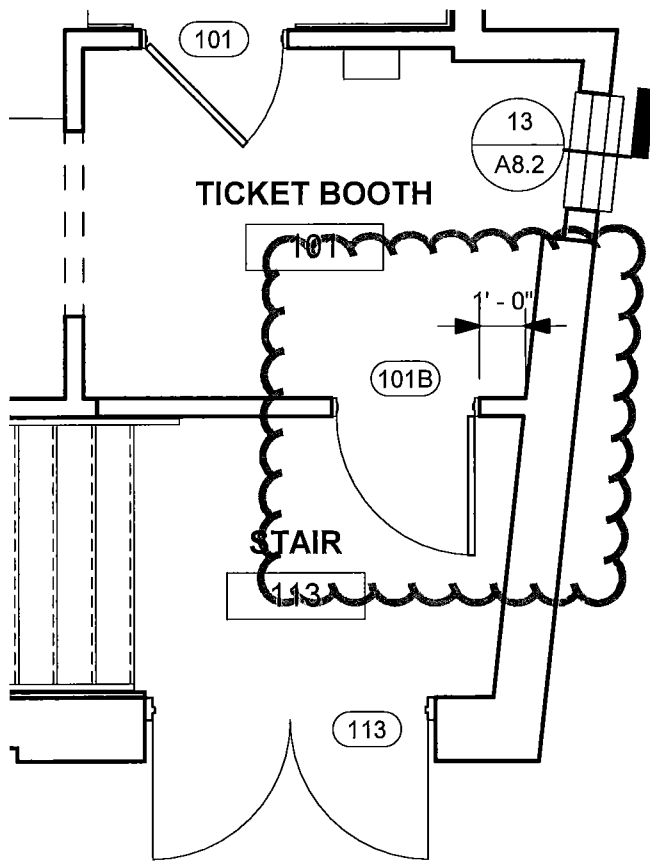

Door 101B  
3'-0" x 6'-8" x 1 3/4"  
Type "E" 2-Panel Wood Solid Core  
Frame Type 2 Wood  
4 3/4" Frame Width (field verify)  
Head Detail 7/A3.1  
Jamb Detail 8/A3.1



## Jeff Lewis

---

**From:** Arielle Schlesinger <aschlesinger@dunwodybeeland.com>  
**Sent:** Tuesday, September 26, 2023 8:56 AM  
**To:** Jeff Lewis  
**Subject:** Re: The Royal Theater  
**Attachments:** image001.jpg

I don't see one that matches the door hardware setup. This door also needs a closer, hinges, and wall stop. Is the door hardware subcontractor capable of putting together a door hardware set for us to review?

Sincerely,

Arielle Schlesinger; ASID  
Dunwody/Beeland Architects, Inc.  
300 Mulberry Street, Suite 604  
Macon, GA 31201  
T: 478.742.5321  
F: 478.743.0863

On Tue, Sep 26, 2023 at 8:34 AM Jeff Lewis <[jlewis@principleco.com](mailto:jlewis@principleco.com)> wrote:

OK, does that match any of the other Hardware Sets previously scheduled by BHE Openings, or similar to any other door(s)?

**Jeff Lewis**

Sr. Project Manager

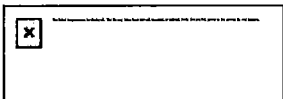

mobile 770.652.1954 | office 706.407.2525

[www.PrincipleCo.com](http://www.PrincipleCo.com) | GEORGIA | ALABAMA

**From:** Arielle Schlesinger <[aschlesinger@dunwodybeeland.com](mailto:aschlesinger@dunwodybeeland.com)>  
**Sent:** Tuesday, September 26, 2023 8:33 AM  
**To:** Jeff Lewis <[jlewis@principleco.com](mailto:jlewis@principleco.com)>

**Cc:** robert beeland <[rbeeland@dunwodybeeland.com](mailto:rbeeland@dunwodybeeland.com)>

**Subject:** Re: The Royal Theater

Jeff,

The door needs a rim exit device (push side) with key-in-lever trim (pull side) that has entry/classroom function.

Sincerely,

Arielle Schlesinger; ASID  
Dunwody/Beeland Architects, Inc.  
300 Mulberry Street, Suite 604  
Macon, GA 31201  
T: 478.742.5321  
F: 478.743.0863

On Mon, Sep 25, 2023 at 3:17 PM Jeff Lewis <[jlewis@principleco.com](mailto:jlewis@principleco.com)> wrote:

Good afternoon Arielle.

Anything yet on Hardware for new Door 101B? I need to get a price on this.

Thanks

**Jeff Lewis**

Sr. Project Manager

mobile 770.652.1954 | office 706.407.2525

[www.PrincipleCo.com](http://www.PrincipleCo.com) | GEORGIA | ALABAMA





**PRINCIPLE**  
CONSTRUCTION

# Change Order Request

<b>Project:</b>	<u>The Royal Theater</u> <u>400 East Main Street</u>	<b>COR#:</b>	<u>04</u>
<b>To:</b>	<u>City of Hogansville</u> <u>111 High Street</u> <u>Hogansville, GA 30230</u>	<b>Date:</b>	<u>10/16/2023</u>
<b>Re:</b>	<u>Revision #4 Changes</u>		

**Description of Change:**  
Changes to Electrical, Low Voltage, and Fire Alarm per Revision #4 drawings. Note: Lighting changes were relative even swap, no additional costs.

<b>Total Cost</b>	<b>ADD</b>	<u>\$50,709</u>
<b>Change in Contract Time</b>		<u>None</u>

**Attachments:**     Pricing Breakdown     Other    \_\_\_\_\_

<b>Signed By:</b>	<u></u>	<u>10-16-23</u>
	General Contractor	<b>Date</b>

<b>Reviewed By:</b>	_____	_____
	Architect	<b>Date</b>

<b>Approved By:</b>	_____	_____
	Owner	<b>Date</b>

Please contact me with any questions that may arise concerning this change order request.



Ideal Electrical Contractors, Inc.

3206 West Point Road  
LaGrange GA. 30240

# Quotation

QUOTE NOT VALID  
AFTER 30 DAYS

Date  
10/12/2023

**Name / Address**

Principle Construction  
51 New Hutchinson Mill Road  
LaGrange, GA 30240

**Project**

Royal Theater Hogansville

**Job Name**

**Acceptance Date**

**Item**

**Description**

**Total**

Estimate	Lighting and Controls Changes, add type L and M remove Type T and B2 ( Other minor changes in counts) no change in price	0.00
Estimate	Add Panels LCP and LD (Materials-\$12,375, Labor-\$2,150)	14,525.00
Estimate	Add additional 2" conduit and wiring per note 11 and 12 on sheet E2 (Materials-\$5,180, Labor-\$6,317)	11,497.00
Estimate	Add 5 Nema L-20 Outlet on stage per note 14 on sheet E2.1 (Materials-\$3,288, Labor-\$1,850)	5,138.00

<b>Subtotal</b>	\$31,160.00
<b>OH&amp;P - 15%</b>	\$4,674.00
<b>Sales Tax (7.0%)</b>	\$1,459.00

<b>Total</b>	<b>\$37,293.00</b>
--------------	--------------------

**Phone #**

706882-2010

**Fax #**

706-882-0443

**E-mail**

IDEAL59@IDEALELECTRICWEB.C...

DH Technology and Security  
72071 PO Box  
Newnan, GA 30271 US  
dhhs2019@outlook.com



# Estimate

**ADDRESS**  
Brent Conrad

**ESTIMATE # 1145**  
**DATE 09/17/2023**

---

SERVICE	DESCRIPTION	QTY	RATE	AMOUNT
<b>Revision 4</b>	<b>Revision 4</b>	1	5,360.00	5,360.00T

---

Revision 4	<b>SUBTOTAL</b>	5,360.00
remote microphone station	<b>TAX</b>	375.20
Expansion zone on Main voice evacuation system.	<b>TOTAL</b>	<b>\$5,735.20</b>
Photoelectric smoke detector		

Accepted By

Accepted Date